

TECREADER - **CORPUS** by Chris Ziegler  
mailto:cz@movingimages.de  
GER tel. +49 172 8956328  
US tel. +1 480 2871023

31<sup>st</sup> May 2017

STAGE: around 10 m \* around 7m

- black box, walls should be dark
- black dance floor
- exit or emergency lights have to be covered by blue gels or dimmed!
- black curtain or black wall with door at rear of stage
- behind stage: small space to change costumes with chair and dimmed small light

PROPS: *we need* a revolving office chair, dark color  
and a table ~2m\*~1m for tec and chair next to stage (see plan)

SOUND: we bring MOTU UltraLite-mk3 Hybrid Audio  
output for TRS/Jack output

- we need a good stereo sound system with subwoofer (D&B or similar),  
sound mixer from theater and audio cabling
  - sound should also come from back of stage
- 4 speakers if possible (front and back)

LIGHTS: we bring small UV Light

- no stage lighting for the show
- some Halogen or similar lights on audience area to block visibility of stage when audience is seated
- no or dimmed emergency lights or other lights from outside on stage! We need a pitch black space.

CAMERA: we bring a small video camera, tripod and video cabling

COMPUTER: we bring Computer and Software / WLAN

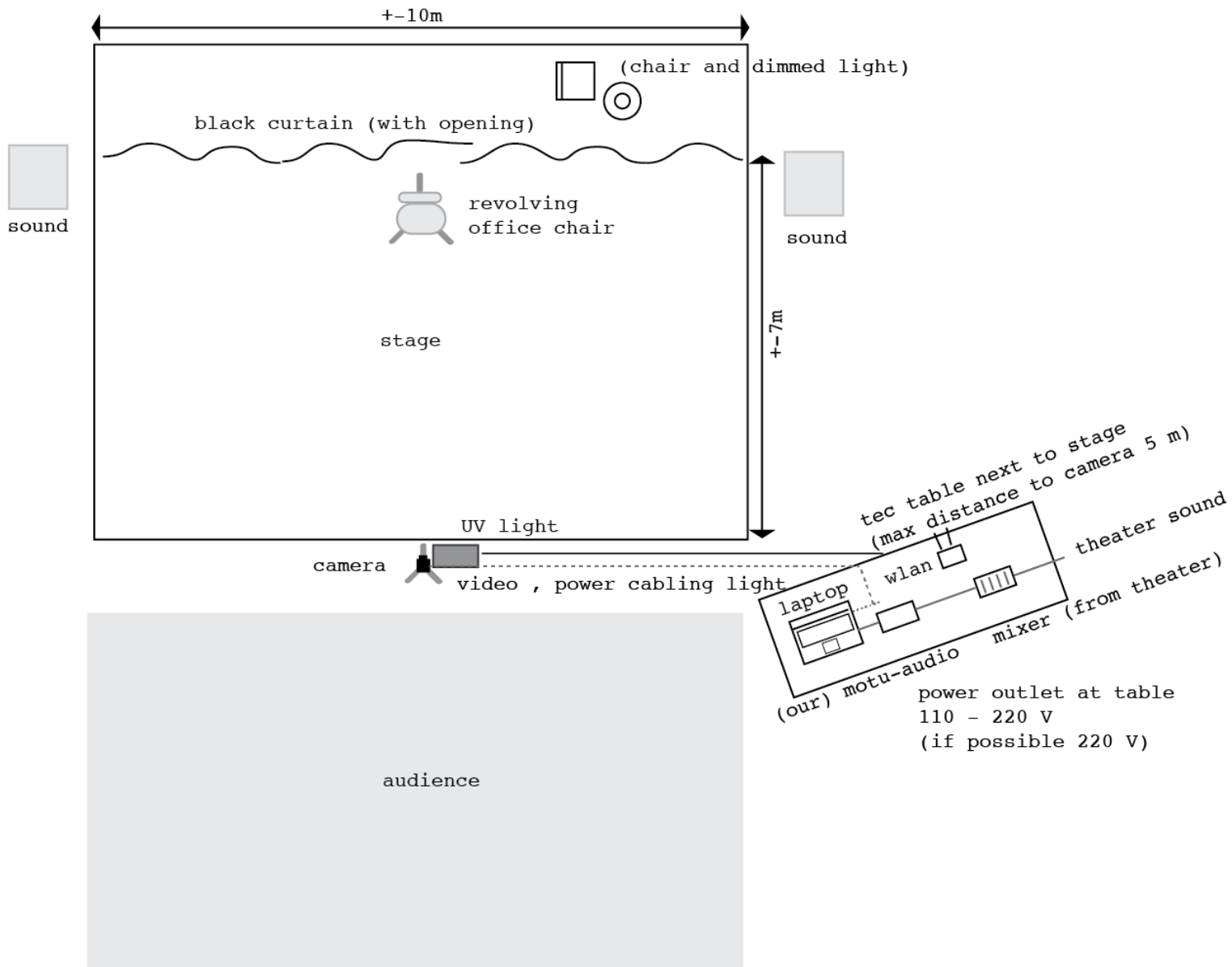

halogen or other room light



black curtain



camera  
UV light

stage



chair



chair + small light